Camp Knutson

ANNUAL

Report
2022

CAMP MISSION

Camp Knutson is dedicated to nurturing the well-being of persons with identified needs in a setting which celebrates God's love for community and creation.



Camp Knutson provides camping services for individuals with disabilities, medical conditions and other identified needs. Camp is open year-round, also hosting retreats, conferences, meetings and trainings September through May.

A Note from the Directors



Jared Griffin
Jared.Griffin@lssmn.org

This year felt like a homecoming – for our campers, retreat guests, volunteers, supporters and everyone at Camp Knutson. Our camp schedule was full for the first time since 2019, and our events were once again held in person.

“Digging In and Building Up.” That was our theme this camp season, and it was what we needed to do to get back in the swing of things. We had a wonderful group of summer staff – including cooks, maintenance team, housekeepers and program staff – who jumped into their roles with enthusiasm and ensured that each week of camp ran smoothly.

Our talented, dedicated group of volunteers are also an integral part of Camp K. They planned our successful fundraising events, worked to beautify camp’s grounds, and interacted with campers.

In terms of building up, we announced an exciting project that we had been impatiently waiting to share: the new Fischer Cabin! With 52 beds, two great rooms and a spacious laundry room, this accessible two-story cabin will allow more campers to experience Camp Knutson in comfortable, updated quarters. You can learn more about Fischer Cabin, and the family whose generosity made it possible, on page 6 of this report.

Welcoming new and returning retreat groups to camp in the beautiful fall weather brought our year to the perfect close.

Thank you for being a part of Camp Knutson. Your gifts of time, donations and friendship allowed us to “dig in” this summer to create memorable and nurturing experiences for our campers. Your partnership has also advanced our plans to “build up” Camp Knutson to touch even more lives in the future. Together, this work is not only possible, but attainable.

With Deep Gratitude,

Jared Griffin
Jared Griffin
Camp Director

Caitlin Malin
Caitlin Malin
Program Director

"This year, we are filled with gratitude for the ability to open our doors to all of our campers, retreat guests, volunteers and supporters once again."

~Jared

THANKS TO YOU!

As we reminisce about our favorite camp memories of 2022, we know that our ability to reunite this summer was due to the support of our Camp Knutson community. Your enthusiasm for our mission and our campers shows in all that you do for us – in time spent volunteering and your generous contributions.

Because of you, this year we welcomed:

- 13 camp partners
- 17 in-person camps with 927 campers
- More than 600 retreat guests

Thank you for your unwavering support of Camp Knutson!





WELCOMING CAMPERS TO 'THEIR FAVORITE PLACE ON EARTH'

Enthusiastic greetings sounded throughout the grounds as American Academy of Dermatology's Camp Discovery campers returned to Camp Knutson after being absent since 2019 due to the pandemic.

"There were great reunions when campers saw people they hadn't seen in years," remarked Ally Garin, director of Camp Discovery. Many of these reunions took place at the airport since Discovery campers travel from across the United States.

"Coming to camp is always a lot of fun," said AJ, a third-year camper. When he heard that camp wouldn't be held in-person in 2020, he recalled feeling disappointed. "I was shocked and mad."

Camp Discovery campers have chronic skin conditions, and many have threatened immune systems. For that reason, Camp Discovery was held virtually during 2020 and 2021.

Camp Knutson is one of the few medically-sound camps that campers with specific medical needs can attend. "It's a week of fun and freedom," said Ally. "They get to create friendships that are unique in that level of understanding."

"Everyone here has something," AJ said. "We just want to have a good week at a judgment-free place."

When it's time to leave, campers are often already looking forward to returning. "Campers are so excited to come back to their favorite place on earth – we hear it called that a lot," said Ally.

**"Camp is their happy place,
their safe space."**



Third year Discovery camper AJ



QUILT AUCTION

We raised more than \$100,000 for the first time ever at the 36th Annual Quilt Auction! More than 200 bidders attended virtually or in person.



ICE TEE OPEN

Thanks to Moonlite Bay Family Restaurant for organizing the 21st Annual Ice Tee Open in February. Camp Knutson supporters played golf on frozen Cross Lake to raise funds for camperships – \$52,000 was raised this year!

NIGHT UNDER THE STARS

Camp Knutson supporters, donors, and volunteers gathered in person for the first time since 2019 for Night Under the Stars. Once again, our generous community came together to raise a record-breaking \$370,000!



FAMILY SUNDAE FUNDAY OPEN HOUSE

We treated our Camp K community to ice cream, tours, games and activities to start our summer camp season.



PANCAKE BREAKFAST

Neighbors, volunteers, supporters and camp families gathered at Camp Knutson over Labor Day weekend to enjoy a pancake breakfast with all the toppings – our way of saying thank you for yet another successful camp season.



MUSIC ON THE DOCKS

Singer-songwriter Mike Derus performed on the Camp K docks for our second annual Music on the Docks concert, the kickoff event for Night Under the Stars



REBUILDING FOR THE FUTURE OF CAMP KNUTSON

Camp Knutson has been an important part of Dave Fischer's life since he and his wife, Marie, retired to Minnesota's Whitefish Chain of Lakes two decades ago. Dave's mother, Cora, had become involved in the camp through her friendship with the mother of then-director Rob Larson.

"When we told my mother we were moving back to the area, her first words were, 'You both need to volunteer at Camp Knutson,'" Dave recalled. "When you get a mandate from your mother, you know you'd better comply!" The couple jumped in and never looked back. Dave has participated in projects ranging from shoreline restoration to serving on the camp's advisory council. Marie, an avid quilter, chaired Camp K's annual Quilt Auction for 15 years, raising more than \$750,000 throughout her tenure.

When Marie passed in 2019, the family suggested that memorial gifts be directed to the camp she had tirelessly supported. Dave pledged a lead gift to help rebuild one of the camp's oldest structures, Crosslake Cabin, in his wife's memory. All three of Dave and Marie's children chose to join their father by donating a portion of their own inheritances to the project. "It was a family decision," Dave said.

The Fischer family's generosity made it possible for construction to begin immediately after the summer camp season concluded in 2022. The Fischer Cabin is scheduled to be ready by the

time campers arrive in 2023.

What began as a favor to his mother has become a deeply personal commitment to Dave. He is grateful knowing that campers who might not otherwise get the opportunity to connect with nature and community will always have a place at Camp Knutson.

"How can you have an impact on generations to come," Dave asked, "beyond your own life?" For him, just as it was for Marie, the answer is Camp Knutson.

The project is more than two-thirds funded through the generosity of the Fischer family and other supporters. You can contribute to the building fund at campknutson.org/donate.



Above: Alise Fischer, David Fischer, Eric Fischer and Craig Fischer at the new cabin groundbreaking on September 9. Crosslake Cabin stands behind them.

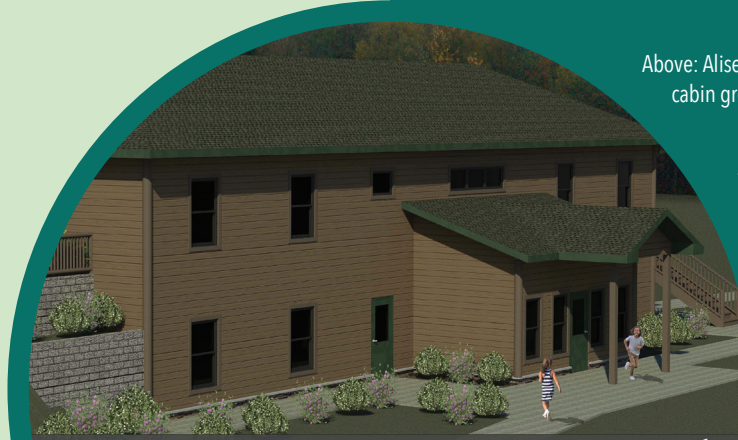

The rebuilt cabin will be nearly twice as large as Crosslake Cabin. It will feature paved entrances, wider doorways, accessible bathrooms, indoor gathering areas and improved laundry and storage facilities. By upgrading its infrastructure to support more accessible housing, Camp Knutson will maximize its potential to be a leading provider of fully inclusive, accessible, medically-sound camp experiences as well as a destination of choice for retreats.

JERI SCHOONOVER'S IMPACT ON CAMP KNUTSON

Over her 35 years at LSS, Jeri Schoonover made an incredible impact on Camp Knutson. Jeri retired in June 2022 after serving as LSS Chief Service Officer.

"Jeri helped make Camp Knutson what it is today," said Jared Griffin, senior director of Camp Knutson. "From the growth of its services, improvements to the grounds and buildings, collaboration with partners, to – most importantly – her vital role in helping establish and support the Camp Knutson culture and reputation for excellence in service to others."

For Jeri, there is a spirit to the camp.

"It's a very magical place," said Jeri. "People establish friendships there. When you see that – the laughter and the engagement and the enjoyment of the whole environment – to me, it just melts your heart."

Jeri's leadership and "can-do" attitude has contributed to Camp Knutson's many successes. One of Jeri's biggest contributions to camp was the construction of the Spokes and Wheels building. In one weekend, Jeri brought together friends and family to take an old storage shack and make it a beautiful – and useful – bike shed for campers.

"It is one of the first buildings you see when you drive into camp," said Jared. "With Jeri being such a welcoming person, it's no surprise that that she made this a personal project to give this space special care and attention to make all campers and guests feel more at home," said Jared.

While Jeri's time working at LSS has come to an end, she still has plans to return to see the progress Camp K is making.

"I have a love for Minnesota lakes," said Jeri. "It is just so heartwarming to really see individuals that may never have had a chance to be on a lake or experience the Northwoods activities, have this opportunity and see the impact on their lives."

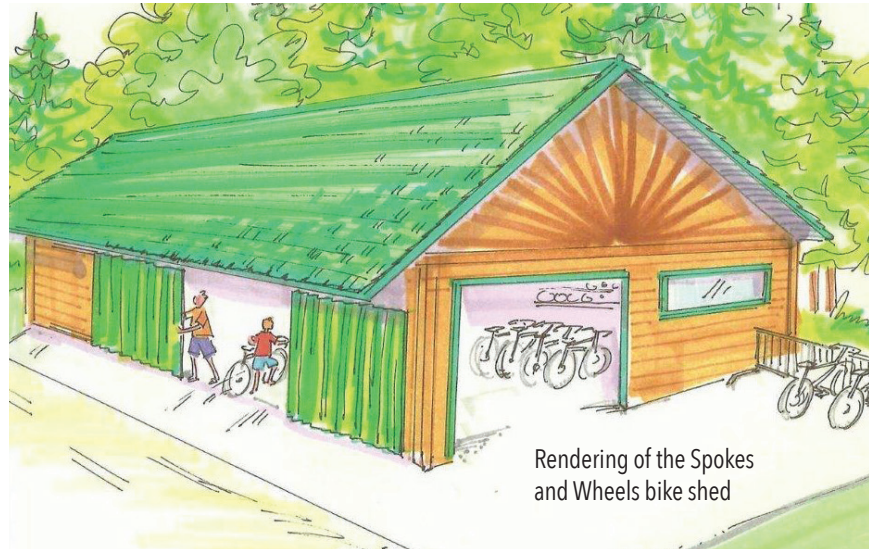

Rendering of the Spokes and Wheels bike shed



Jeri Schoonover



BEST WISHES TO PAT AND SARA!

This fall, we bid farewell to our food service co-directors: the mother-daughter team of Pat True and Sara Larson. Pat joined Camp Knutson's staff in 1993 as the evening cook. Sara would come help her mom as assistant cook as a teenager, later spending several summers as Camp K program staff. In 2005, Pat and Sara shared the role of lead cook before transitioning into co-directors.

While we're excited for them as they embark on new paths – retirement for Pat and a move to North Dakota for Sara – we were sad to say goodbye.

Thank you, Pat and Sara, for your years of service to Camp Knutson!



Sara Larson & Pat True



DONORS

Camp Knutson is grateful to our many supporters. This list recognizes outright gifts, pledges and in-kind gifts that were given between October 1, 2021 and September 30, 2022.

INDIVIDUALS

Anonymous (2)
Victoria and William Abbott
Jeannine and Keith Acker
Ashley and Justin Adducci
Debbie and Michael Adducci
Dennis Ahlschilager
Janell F. Akerson
Linda Anderson Koch
Carol and Dave Anderson
Carol and Larry Anderson
Darlene A. Anderson
H. Jean Anderson
James A. Anderson
Jodie Anderson
Julane and Rodney Anderson
Karlyn and Donald Anderson
Kristy Anderson
Mary Anderson
Shannon and Todd Anderson
Tait G. Anderson
Shelby Andress
Robert Andrews-Mendoza
Marjorie Angell
Connie and George Aram
Jeanne and Gary Arntzen
Miranda Aulie
Kendall Austin
Peter C. Austin
Kathleen and Bob Bahma
Mary and William Bahnfelth
Elaine and Neal Bailey
Deanna and Glenn Bakke
Jean Ann Banker
Andrea and Robert Barbknecht
Paige and Martin Barnard
Nancy and David Barnes
Elizabeth and Jeff Bartholomew
Katherine Baumgartner
Sharon Beaver
Trina Becker

Trish and Russ Becker
Kelly and Thomas Belin
Mildred and Richard Benjamin
Bonnie and Jeffrey Benson
Cathie Benson
Kenneth G. Benson
Kayla Benzick
Barbara and Mark Berens
Christy Berge
Cynthia and Jefferson Bernards
Mark Bialon
Toni and Jamie Bieser
Cynthia and Milton Bighley
Thomas Billigmeier
Adam Bilski
Jackie and Michael Bilski
Jocelyn and Matthew Bilski
Laura and Alex Bilski
Londa and Dennis Bilski
Sandra and Gerald Bilski
Cheryl Blair
Kathleen Blatz and Gregory Page
Kelsy and Michael Blowers
Gail and John Boline
Sue Bolton and Greg Hicks
Mary and Robert Borgeson
Margaret and Allan Bostelmann
Barbara and Leroy Boyer
Jacquelyn and James Brandt
David Bratland
Jane and Don Brattain
Melanie and Robert Brauer
Lacey Breidenbach
Thomas Brinkman
Mardy and Joe Brodill
Curtis Brown
Karen and Harold Brown
Lynda and John Bruder
Penny Bryce
Gerald Bublitz
Julie and Daniel Burkhardt

Jane Burmeister
Judith Burrichter
Sarah Calatayud
Edward Caldwell
Mary A. Campbell
Eileen and Steve Canakes
Deborah Mueller Carlson
Heidi Carlson
Kathleen and Richard Carlson
Ruth Carlson
Edwin Carpenter
Nancy and Robert Christensen
Teresa and Joe Christensen
Kathryn Christenson
Karen and James Clapper
Jacklynn Clark
Kate and Mark Colburn
Kelly and Mary Conger
Karen and Theodore Contag
Madalin Coppock
Patricia Cormaney
Jo Corr-Elsenpeter and J.P. Elsenpeter
Jo Ann Cox
Corrie and Don Craig
Howie Crawford
Sharon and Frank Cserpes
Linda and Robert Culbertson
Linda Curtis
Laurie and David Dahl
Marjorie Dahlager
Mark P. Dahlen
Debra Dahlke
Glen Dall
Margaret and William* Dammann
Jan and Elgene Darnell
Marilyn A. David
Jenny and James Davis
Emily Deal
Maggie Debner
Jaime and Casey Decker
Leslie and Doug Deeter

Sarah and James DeJean
Mike Derus
Jacqueline and Mike Di Giacomo
Brenda T. Dickinson
Teran Dickinson
Janet and Steven Dietz
Jill Dietz
Mike Dietz
Richard O. Dietz*
Trish and Doug Dirks
Nancy and Russell Doering
Daniel Dougherty
Beverly A. Draeger
Julie Drechsler
Andrea and Chuck Duddingston
Andrea and Stephen DuMont
Patricia Dunn and Robert Holbrook
Janet and John Durham
Johanna and Curtis Eastman
Wendy and Mark Ebert
Tiffany and Joseph Eckberg
Andrea and Erik Eckman
James G. Eckman
Kay and Matthew Eckman
Connie and Kent Effinger
Ed Egan
Sally Egan and Bill Terry
Marilyn and Gordon Eid
Jessica and Richard Eide
Anne and James Eidsvold
Claudia and Richard Eklund
Margery and Wallace Eklund
Sharon and Richard Elmquist
Dianne H. Engstrom
Galene and Douglas Erickson
Jean H. Erickson
Lynette Erickson
Patrice and Jeffrey Erickson
Phyllis Erickson
Richard L. Erickson
Joani Essenburg

Kathy C. Everson
Suzanne Fabel
Rachel and David Faldet
Agnes and Robert Falddeen
Kathy and Joe Faust
Myra and Donald Faust
Brenda Fedor
Saundra and Ralph Fedor
Kristin and William Fenech
David R. Fischer
Janet and Steven Fischer
Lisa and Michael Fix
Amy and Rhett Fleming
L'Image Tom Flore
Catherine Flynn
Elizabeth Forde
Karen and Paul Forde
Linda Forsythe
Kelsie Foster
Mindy and Ian Fowler
Sharon M. Frankenfield
Joan Fredeen
Kathy and Bill Fredell
Marcia and Edward Ferek
Carolyn and Raymond Frisch
Jeanne and Glen Frischmon
Charisse A. Froemke
Sheila and Dennis Fry
Becca Fuller
Karen and Denis Fullerton
Jane and Dorman Fulton
DeAnne and Todd Furan
Matthew Gallaway
Kris and David Gardinier
Linda and Richard Gates
Mara Gawarecki
Deb and Tom Gearou
Jean Gebhard
Leslie and Randy Geerdes
Geraldine and Jim Gefre
Geraldine Gendreau



DONORS continued

Margaret Giese
Christi Gillis
Virginia Glenn
Liz Glock
Patricia and Robert Glorvick
Janice Godeke
Pamela Goerges and Jody Stewart
Eleanor and William Goodall
Marcia K. Gray
Joanna and Jared Griffin
Justy Griffin
Mary Colleen and Allan Griffin
Michaela Griffin
Laura Gruhkle
Linda and Craig Gustafson
Dorothea and Ed Gutzmann
Corinne and Tim Hacht
Haglund Kids
Delphy and Duane Haglund
Kelly and Mike Haglund
Jantze and Dennis Haley
Denise Hall
Judith and Bruce Hall
Helene Hammond
Melani and Troy Hanisch
Rochelle Hanisch
Patricia and Marvin Hannon
Betty and Jon Hansen
Barbara and Kent Hanson
Jeff Hanson
Marilyn A. Harder
Greta Harmala
Jodi and Stan Harpstead
Patricia Harrison
Susan Hartig
Karen Hartje
Jeneen Hartley
Theresa Hartson
Diane and Danny Haugen
Garen B. Hebeisen
Joanne and Jack Heidman
Cynthia and Mark Heigl
Michele and Jerome Hein

Barbara and Randy Hemstad
Catherine Hendrickson
Nancy and Mark Hendrickson
Sharon and William Hennemuth
Laura Hermansen
Lise Herren
Patricia and Keith Hesli
Denise and Charles Hicks
Vicky Hidalgo
Marty and Don Hillerich
Karen and John Himle
Mary and Roland Hirman
Ardys Y. Hjerpe
Julianne and Bruce Hjerpe
Rosa and Michael Hoagland
Nancy and Gerald Hoehn
Sheila and Chris Hoehn
Marti Hofer
Joan and Gerald Hoffman
Joe Hogan
Martha Holland
Lois Holzemer
James P. Holmes
Sarah Howard
Susan E. Howell
Elizabeth and Felix Hsu
Sigrid and Roger Hubley
Peggy and Russ Huffer
Carla and Paul Hummel
Charlie Hummel
John Hummel
Linda and Glenn Hummel
Richard Hummel
Melissa and Michael Huray
Bethany and Paul Husby
Joseph Husby
Ann E. Hutchings
Kim Ingalls
Joyce Iverson
Jody Jackson
Laurie Jacobs
Sharon Jacobson Year
Sheila Jacobson

Laura and Doug Jaeger
Meredith Jaeger
Michelle Jamar
Carmen Jastrow
Joanne* and Kenneth Jensen
Beverly and Halvor Jerde
Douglas Johanson
Betty* and Paul* Johnson
Bonnie and Thomas Johnson
Carol and Gary Johnson
Christine and Richard Johnson
Cindy and Paul Johnson
Cynthia Johnson
Joy and Craig Johnson
Karen L. Johnson
Kathleen and Orville Johnson
Kendra Johnson
Linda and James Johnson
Jean and Dave Jones
Fontina and Lyle Joyce
Yvonne L. Kalahar
Gail and Claude Kane
Jenny Kane
Kathryn Karlman and
Christopher Clysdale
Kathleen and David Keeling
Sharon and Richard Keister
Jean and Edward Kellogg
Jeremy Kelzer
Kirsten and Brian Kemp
Tona and Colin Kerslake
Mahrukh and Joe Khawaja
Roger Kingstrom
Jane and Gary Kipling
Dorothy F. Kirk
Charlene Kirschbaum
Martha Kjeseth-Johnson
Sandra and Robert Klas
Jane and Warren Kleinsasser
Tina Knebel
Marcia Knutson
Pamela and Daniel Kocer
Marilynn and Ron Koehler

Vicki and Gerald* Kopplin
Jenni Kornbaum
Barbara and Chris Kotsmith
Susan M. Krabbenhoft
Mary Kramasz
Judith and Robert Krammer
Barbara and Thomas Krawczewski
Karen and Kurt Kreienbrink
Shari Kreye
Gloria and Norman Koreger
Connie Krueger
Dewey Krueger
Mary and Joe Kuehn
Katherine Kuettel
Dina and Jason Kuhn
Pauline Kuhn
Katherine Kunkel
Alice and Bob LaBarre
Rob Lane
Andrew Larson
Carla A. Larson
Donna and Kevin Larson
Jan and Jack Larson
Karen and Ronald Larson
Leah Larson
Sally and Daniel Larson
Sara and Eric Larson
Janet and Jeffrey Laurel
Heidi Leach
William Leadens
Rebecca and Joel Ledermann
Karen Lee
Lori and Ronald Lee
Patricia Leek
Catherine Leiendecker Foster
Dawn Leitch
Kathe L. Lemmerman
Lynne and Daniel Leonardi
Jennifer amd Dennis Leslie
Carla and Harold LeVander, Jr.
Erica and Chris Liesmaki
David Lind
Jane Lindell

Maureen and Wayne Lindholm
George Loban
Jan Lobben
Mathew Loehlein
Susan Lommen
Mary and Gordon Long
Elyse and Robert Longo
Karen and Todd Lovaas
Kimberly Loven-Gregory
Barbara and Terry Lowe
Kaylen Lowe
Lisa Lund
Carole and Donald Lundquist
Susan and Erik Lundquist
Deb and Dave Lutz
Barbara and John Lynskey
Louise and Scott Lystig Fritchie
Carol Madison
Richard Magnuson and
Charles Swenson
Caitlin R. Malin
Laura and Paul Malin
Phyllis and Alvin Malin
Susan Manrodt
Pam Marlatt
Mary Marshall
Carole Martens
Lori and Michael Martin
Caroline and Dan Mason
Patricia and John Matthews
Karen McCulloch
Barbara J. McKay
Julie and Neil McKay
Anne and Jeffrey McLaughlin
Garrett McLaughlin
Lynette McLaughlin
Greg McNeely
Ellen McVeigh
Sharon Meister
Kathleen and Robert Mellas
Cynthia and Lee Melsby
Dina and Mark Menth
Tory and Brian Merhar

2022 CAMP KNUTSON ADVISORY COUNCIL

Le Boyer

Annalisa Eckman-Rudser

Dick Erickson

Dave Fischer

Allyson Garin

Jared Griffin

Corinne Hacht

Jenna Hanson

Deb James

Steven James

Rob Larson

Caitlin Malin

Anna Mason

Dan Mason

Tory Merhar

Judy Morgan

Mary Ella Pratte

Jeri Schoonover

Josh Sitarz

Dan Thorson

Kathryn Tiede

Mary Kate Williams

Susann Zeug-Hoese



Virginia Merrill
Kathy L. Metcalf
Kenneth W. Meyer
Doris and Jan Mezzenga
Carol and Michael Mikesell
Ann Miller
Brenda Miller
Deb and Dan Miller
Esther and Artie Miller
John Miller
Kathryn and Russell Miller
Patricia and David Miller
Renee and Bradley Miller
Andrew C. Million
Andriette and Steve Million
Katie Million
Jane Milliman
Jean H. Milton
Debbie Mirau
Janice and Robert Moengen
Jane Mohr
Paul M. Mohring
Martin Mollenkamp*
Ruth and Glenn Monson
Sherry L. Monson
Anne and Thomas Mootz
Sharon L. Moran
Judith A. Morgan
Ronda and John Morin
Bonita and Dennis Morris
Cindy and Brad Morris
Janice and John Mozey
Mary Alice Mraz
Kim and Michael Muehlbach
Martha Mumaw
Kathy and Tim Murnane
Molly and Nick Murnane
Maureen and Kevin Murphy
Colleen and Doug Murray
Debbie Musolf and
Arthur Wineman
Carol and Kent Musser
Cynthia Muth

Joan and Ernest Myer
Cheryl and Gregory Myhr
June and Robert Myller
Barbara Neal
Molly and Russ Nelsen
Angela and Darryl Nelson
Carol Nelson
Charles A. Nelson
Claire and David Nelson
Kathleen and Larry Nelson
Lori and Herbert Nelson
Mary and James Nelson
Myra and Terry Nelson
Patty and Brad Nelson
Ruth E. Nelson
Susan Nelson
Penny Nemgar
Sarah Nemgar
Cheryl and Rick Newell
Susan Newsome
Jill and Greg Newville
Jen and Paul Nick
Judy and Steve Nick
Sarah and Dave Nicoll
Donna and Mark Nielsen
Mary and David Nielsen
Mary Nienaber
Laurie Noll
Joyce Norals
Diane Nordstrom
Sandy and Darrell Norling
Alissa Norquist and Chris Blahna
Sandy and Bruce Norrgard
Lisa M. Northagen
Lorraine M. Northagen
Anne O'Brien
Haley and Mike O'Connell
Elaine V. Ogren
Debra and Olaf Olsen
Erika Olson and Peter Eckman
Gwendolyn and Dale Orred
Jan and Glenn Osmonson
Tom Ottoson

Michelle and Tom Palmquist
Amanda Panzer
Bev and Dennis Panzer
Lisa and Bruce Paradis
Suzanne and Daniel Parker
Joann and John Pastorius
Mary J. Paulson Peterson
Gerald Paulson
Sara Payne
Martha and Marshall Pechauer
Kathleen and Jeffery Pepski
Carol and Steven Pestorious
Brenda Peterson
Brent Peterson
Darcy and Wayne Peterson
Fern Peterson
Gloria Peterson and
James McCarthy
Illene and Martin Peterson
Jane and Art Peterson
Katherine and Robert Peterson
Kim and Shawn Peterson
Linnea and Stephen Peterson
Lisa Peterson
Marian and Dave Peterson
Megan and Christian Peterson
Susan and Gary Phillips
Terese and Dennis Piper
Jeanne and Joseph Polaczyk
Mary and Gary Polaczyk
Ann Pollard
Jane and Jerry Pollock
Avalon Porta
Mary Ella Pratte
Barbara and John Pribyl
Laurel G. Price Jones
Coral and Reid Price
Gloria and Dennis Priem
Anne M. Pudas
Andrea Racioppi
Linda and Bill Randall
Gordon J. Rausch
Kristine and Scott Reddy

Margaret and Loren Rehmer
Margaret Reier
Jane and Donald Reierson
Linda and James Renner
John Repp
Reginald Rettinger
Elynn M. Rhein
Sharon Rhodes
George Riches
Laurie and Michael Ridgley
Janet and Jim Ringquist
Karna Rinke
Lisa and Craig Ritzinger
Michael Rocheford
Beryl and Stephen Roe
Kristi and Frank Roedl
Sylvia and Richard Rog
Debra Rogers
Cheryl Rohrbach
Linda Roitburd and
Patrick McShane
Mary and Gregory Rom
Julie and Allan Rose
Nancy and Jeff Rosemore
Linda Rossi
Carol W. Rossman
Sharon E. Rouse
Bonnie Rowan and
Douglas Norwood
Annalisa and Kyle Rudser
Colleen and Richard Ryan
Jennifer and Edwin Ryan
Heidi N. Samsel
Jay Sandlow
Christa Sands
Betsy Santi
Joy and Gary Sarner
Sarner Family
Bonnie R. Sass
Renelda and Donald Sather
Georgina C. Savat
Jeanne and Scott Savitt
Linda and James Sawyer

THANK YOU, VOLUNTEERS!

Camp Knutson truly has the best volunteers around. Thanks to each of you who helped plan our successful fundraising events, performed building and yard maintenance, grilled and served food on tailgating nights, and put an abundance of time and energy to help make camp an unforgettable experience for our campers.



DONORS continued

- Shirley Schaefer
Polina and Bryan Schindel
Braden M. Schmid
Margaret and Kim Schmidt
Brigitte Schneider
Michele and Kirk Schnitker
Jodi and Phillip Schott
Patricia and Paul Schroeder
Kimberly Schulte
ReNee Schumacher
Shari and Donald Schumacher
Eva Schwartz
Ann and Roger Seapy
Gretchen and Chris Sebald
Pasibeth and Craig Seeman
Louise Severson
Lucille B. Severson
Charles Sewall
John Shamp Family
Nancy and Alan Sherburne
Jane and John Sherman
Ann and Sam Shirey
Shirley and Glendon Shodahl
Sharyl and Robert Sicoli
Carolyn and Roy Silcox
Helen and Ted Silva
Elaine Sime
Alyse Simondet
Betsy and Gary Simons
Catherine and Gary Simons
Gayle and Jim Simons
John Simons
Sue and Bob Simons
Linda and Stephen Simonson
Lonnie and Paul Simonson
Mary Simonson and Dean Andrews
Rosalind and Laurence Sinesio
Brenda and Timothy Singer
Bob Sitarz
John Sitarz
Natalie and Richard Sitarz
Robyn and Rick Sitarz
Tom Siwek
- Karen and Joel Skagerberg
Dedra and Paul Slack
Constance and Keith Smeby
Allie Smeeth
Alice and Newton Smith
Gail Smith
Janet and Brad Smith
Mary and Jeff Smith
Karen Snedeker
Ruth and Dayton Soby
Pamella and David Sonnichsen
Lisa Sorensen
Trese and Tom Sorensen
Michelle and Richard Spady
Shelley and Dean Spencer
Evan Spevacek
Kathy and Phil Spevacek
Sandra Spidel Neumann and Neil Neumann
Rachel and Nick Spies
Teresa Sposito
Jean An Sprague
Sharon and John Stark
Janice W. Steadland
Donna Stenberg and Steve Reed
Jean and Mike Stevens
Terri Strachan
Janet Strand
Mary Ann Strand
Sarah and Jesse Stremcha
Amy Sunderland
Joan Sunram
Adele J. Suomela
Kari and Craig Swandal
Lisa Swanson
Susan and Darrell Swanson
Laurie Sweeney
Ann and Thomas Swenson
Mary Taleen
Kelly Taschler
Carole* and Ralph Taylor
Lisa and Bart Taylor
Marjorie and Robert Templeton

Paul L. Terrio
Kristen L. Thatcher
Brandi Theis
Juliann and Stephen Thomas
Sandi and Daniel Thorson
Linda and Michael Thurk
Kathryn Tiede and Gary Guptill
Pamela and Richard Traeger
Aimee Trechock-Peters
Patricia and Stefan* True
Diane and John Tye
Kimberly and Steven Umland
Karen and John Vanderheyden
Cynthia Vargo
Barbara and Vance Vinar
Donna and Robert Waataja
Sallyann* and William Wacker
Marie and Anthony Wagner
Kristine and Greg Wammer
Maureen Warren
Sharene Gossen Watsen
Shelley and David Weaver
Deanne Weber
Charleen* and Donald* Weidenbach
Curt Weitnauer
Gretchen and Todd Wenzel
Jerilynn Wenzel
Mary Werft
Linda and Dennis West
Sally West
Sheryl West
Barbara and Don Wetter
Rebekah Wharton
Donna and Paul Wheeler
Anita A. Whichello
Anja and Gene White
White Family: Maggie, Zach and Alex
Lucy and Richard Wilhoit
Colin Williams
Mary Kate Williams
Ann and Don Wilson
Ellie Wilson
Lynda Wilson
Marc Wing

Florence Wodarz*
Colleen and Kevin Wojciechowski
Judith and Randy Wojcik
Charlie Wolf
Lo Anne L. Worth
Diane and Paul Wotta
Cheryi and Kevin Yager
Jay Young
Julie and Robert Young
Linda Youngs
Mary Zajicek
Kathleen and Leon Zender
Theresa Zeug
Susann Zeug-Hoese and Joel Hoese
Sandra and Donald Zimmel
Pamela and Ervin Zinter

BUSINESSES

66 Marine North
Andy's Bar and Grill
The Animal House
B and B Farmco
Bertha Boatworks
Border View Lodge
Brainerd Glass Company
Breezy Point Golf Course
C & C Boat Works
C & L Distributing
Cancion Tequila
Cashwise Liquor
Cedar Chest
Chanhassen Dinner Theatre
The Chocolate Ox
CoCo & Co
The Cottage Place
Crosslake ACE Hardware
Crosslake Auto Body
Crosslake Coffee
Crosslake Dairy Queen
Crosslake Drug
Crosslake Hair Company
Crosslake Heart Safe Community
Crosslake Sheetmetal
Crosswoods Golf

Crow Wing Kayaks
Dahlheimer Beverage
Deacons Lodge Golf Course
Eagle's Landing Golf Club
Eide Fox and Fur
Emily Greens Golf Course
Encompassing Beauty
First National Bank North
Fladeboe Advancement
Focus Sales
The Fun Sisters Botique
General Store of Minnetonka
Glory Hill Studios
Golden Eagle Golf Club
Goodin Company
Grand Champion Meats
Grandview Lodge
Great Furniture Gallery
Herregan Distributors, Inc.
Highline Hardwoods
Holly's Hair & Nails
Hy-Tec Construction
It's a Wing Ding Thing
Kicks On Route 66
Lakes Area Gallery and Frame Shoppe
Lakes Country Craft and Cones
The Landing Marketplace
Lands End Development, LLC
Landsburg Landscape Nursery
Larson Group Keller Williams
Leslie's Botique
Lundrigan's Clothing Inc.
Manhattans
Maucieri's Italian Bistro
Merritt Jewelers
Mike's Tree Company, LLC
Minne Lake Canoe Co.
Minnesota T's Inc.
MN Adult and Teen Challenge
Moonlite Bay Family Restaurant
Moonlite Square
North American Banking Company
North Country Plumbing and Heating
Northland Pet Lodge

Northland Press
Outlet Recreation
Phillips Wine and Spirits
Pine Peaks Restaurant
Pine River Riding Stable
Pinetree Patchworkers
Quirks
Rafferty's Pizza Restaurant
RBA Consulting
Red Raven
River Valley Restoration
Salon Couture
Serenity Spa at Brezy Point Resort
The Sheek Boutique
Signature Signs, LLC
Simonson Lumber
Simply Rustic Floral Design
Snarky Loon Brewing Co.
Spirits of Nisswa
Squirrely Mama
Structural Buildings
Sysco
Trana Masonary
Ulteig
Valeri Ann's
Wannebo Excavating
Waterfront Services
Whitefish Area Property
Owners Association
Whitefish Automotive, Inc.
Whitefish Golf Club
Whitefish Lodge & Suites
Whoot Designs
Wildwedge Golf and RV Park
The Wine Group
The Woods Landscaping

CHURCHES

Bear Creek Lutheran Church Women,
Grand Meadow
Bethlehem Lutheran Church,
Brainerd
Bethlehem Lutheran Church,
Proctor

Christ Lutheran Church,
Lake Elmo
Community of Grace Lutheran Church,
White Bear Lake
Crosslake Lutheran Church
Crosslake Presbyterian Church
Eidsvold Lutheran Church,
Bay City
First Lutheran Church Women,
Fergus Falls
First Lutheran Church,
Little Falls
Gloria Dei Lutheran Church,
Saint Paul
Holy Cross Lutheran Church,
Duluth
Incarnation Lutheran Church,
Shoreview
Lord of Life Lutheran Church,
Baxter
Mansfield Lutheran Church Women,
Alden
Marshall Lutheran Church Women,
Adams
New Life Lutheran Church,
Rothsay
Our Savior's - Ten Mile Lake Women,
Dalton
Our Savior's Lutheran Church Women,
Outing
Trinity Lutheran Church,
Brainerd
Trinity Lutheran Church,
Cass Lake
Zion Lutheran Church Women of Amor,
Battle Lake
Zion Lutheran Church Women,
Grand Rapids
Zion Lutheran Church,
Milaca





DONORS continued

FOUNDATIONS / ORGANIZATIONS

American Legion Club
 Edward R. Bazinet Foundation
 Bergquist Sunshine Fund
 Brainerd Lakes Area
 Community Foundation
 Camp Knutson Volunteers
 Charles Aid Foundation
 Conway Charitable Lead Annuity Trust
 Crosslake Quilters
 Ecumen Seasons Retirement
 Community at Maplewood
 Emily Loon Crafters Quilt Guild
 Emily Quilters Group

Friday Morning Coffee Group
 Goodin Company Foundation
 Grace Quilters
 Hardenbergh Foundation
 The Clarence Holden Charitable Trust
 KJ Living Trust
 LASAC Inc Senior Morning Club
 Carl and Aune Lind Family Foundation
 Margaret Rivers Fund
 Patch Foundation
 River Valley Quilters
 Louis and Mary Kay Smith
 Family Foundation
 Team West

Third Saturday Club
 Thomas Kemp Foundation

* deceased

**THANK YOU FOR YOUR
 EXTRAORDINARY SUPPORT
 IN FISCAL YEAR 2022!**

If we have forgotten a name or made
 an incorrect listing, we apologize.
 Please let us know. 218.543.4232

IN HONOR OF

Sandy and Jerry Bilski
 Judith and Randy Wojcik

Stacie Bishop
 Sarah Calatayud

Jonah Davis
 Jenny and James Davis

**Alyssa Ducatelli and
 Logan Schultz**
 Joan and Ernest Myer

David Fischer
 Andrea and Robert Barbknecht

Robert Haines
 Kathleen and David Keeling

Humphrey Hanley
 Mindy and Ian Fowler

David Holzemer
 Lois Holzemer

Nikki McBrien
 Kelly Taschler

Layla Nick
 Judy and Steve Nick

Carol and James "Jay" O'Neill
 Joan and Ernest Myer

Margaret Pederson
 Judith A. Morgan

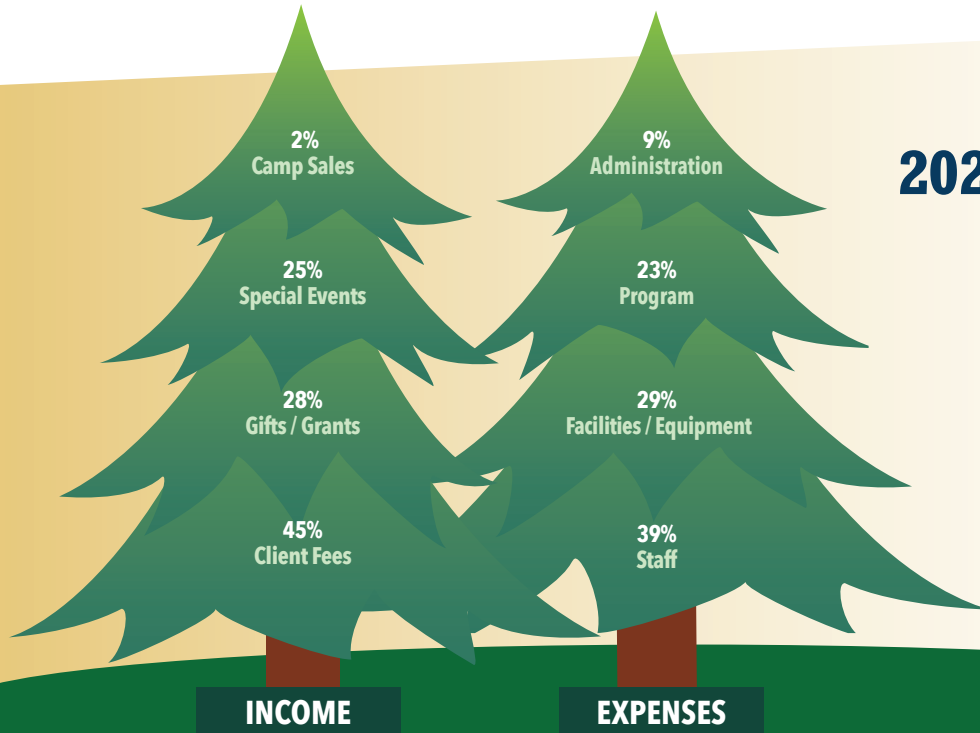

2022 FINANCIALS*

\$1,299,460**

total amount raised by
 community fundraisers,
 gifts and grants

670

number of donors

*unaudited numbers

**portion of proceeds designated for new cabin fund

IN MEMORY OF

Joseph E. Polaczyk

Sandra and Robert Klas

Lynda Rocheford

Michael Rocheford

Viola and Arnold Schlecht

Saundra and Ralph Fedor

Betsy and Gary Simons

Catherine and Gary Simons

Janet L. Strand

Mary Ann Strand

Alex and Jeff Theismann

Michele and Jerome Hein

Sandi and Dan Thorson

Sarah and James DeJean

Mary Kay Williams

Joann and John Pastorius

Kurt Acker

Jeannine and Keith Acker

Eileen and Steve Canakes

Sandra R. Adducci

Sandra and Gerald Bilski

Jim Anderson

Tait G. Anderson

Mary Brubacher

Martha Holland

Lydia & Donald Brynildson

Aimee Trechock-Peters

Bob Carlson

Ruth Carlson

Gordon J. Rausch

Sue Christensen

Peter C. Austin

Nancy and Robert Christensen

Mary Lu Dietz

Crosslake Presbyterian Church

Jill Dietz

Louis and Mary Kay Smith

Family Foundation

Mary Lu & Dick Dietz

Janet and Steven Dietz

Mike Dietz

Charlotte Erickson

Johanna and Curtis Eastman

Phyllis Erickson

Beverly and Halvor Jerde

Carol and Kent Musser

Gretchen and Todd Wenzel

Marie Fischer

Marie and David Fischer Family

Irene Hagen

Beverly and Halvor Jerde

Bonnie Hummel

Mary and William Bahnfelth

Elizabeth and Jeff Bartholomew

Cynthia and Jefferson Bernards

Friends and Family of

Bonnie Hummel

Carla and Paul Hummel

Charlie Hummel

John Hummel

Linda and Glenn Hummel

Richard Hummel

Beatrice A. Jepsen

Elyse and Robert Longo

Mary Nienaber

Sharon and John Stark

Juliann and Stephen Thomas

Einer Jepsen

Renee and Bradley Miller

Juliann and Stephen Thomas

Betty Johnson

Linda and James Johnson

Paul Johnson

Betty Johnson*

Jill Jorgenson

Rachel and David Faldet

Jerry Kopplin

Gail and John Boline

Thomas Brinkman

Sharon and Richard Elmquist

Geraldine Gendreau

Marti Hofer

Ann E. Hutchings

Cynthia Johnson

Friends and Family of Jerry Kopplin

Jennifer & Dennis Leslie

Jane Lindell

Patricia and John Matthews

Lori and Herbert Nelson

Diane Nordstrom

Anne M. Pudas

Margaret Reier

Gayle and Jim Simons

John Simons

Sue and Bob Simons

Karen Snedeker

Marie and Anthony Wagner

Donna and Paul Wheeler

Donald John Leslie

Barbara and Thomas Krawczewski

Ken Merrill

Virginia Merrill

Eldon Munholland

Agnes and Robert Faundeen

Barbara and Randy Hemstad

Barbara and Chris Kotsmith

Lori and Michael Martin

Kathryn and Russell Miller

Paul Polaczyk

Jeanne and Joseph Polaczyk

Mary and Gary Polaczyk

Amy Sunderland

Mabel & Clarence Roe

Beryl and Stephen Roe

Betty Ryan

Colleen and Richard Ryan

Esther & Sterling Simonson

Mary and Gordon Long

Alice and Bob LaBarre

Lonnie and Paul Simonson

Carole Taylor

David R. Fischer

Avalon Porta

Cheryl Rohrbach

Friends and Family of Carole Taylor

Patricia A. Terry

Greg McNeely

Sharon Weinel

Melani and Troy Hanisch

Tom Williams

Andrea and Robert Barbknecht

Judith A. Morgan



Camp Knutson

11148 Manhattan Pt. Blvd.
Crosslake, MN 56442
218.543.4232

camp.knutson@lssmn.org



campknutson.org



Camp Knutson is a service of Lutheran Social Service of Minnesota



CAMP PARTNERS

American Academy of Dermatology / Camp Discovery
serving youth with skin conditions

Ampersand Families
serving youth who have recently been adopted
and their families

Autism Society of Minnesota / Camp Hand in Hand
serving youth and adults with autism

Bridging Hearts
serving young adults with learning differences

Camp Benedict
serving families impacted by HIV/AIDS

Camp Odayin
serving youth with heart disease

Children's Cancer Research Fund / Camp Norden
serving youth affected by cancer

Down Syndrome Foundation Camp
serving youth with Down syndrome

Firefighters for Healing / Camp RED
serving youth who are burn survivors and their families

LSS Youth Services
serving youth experiencing homelessness

Minneapolis Community Group
serving adults with mental health needs

TheShop, Brainerd
serving youth experiencing homelessness

